

**Item Application Sample**



**General Information and Description**

The 14 liter capacity, heavy duty plastic bucket with lid, handle and attached clip-on cap is a family or individual drinking water container for general household use. Made of virgin HDPE high density polyethylene and virgin LDPE low density polyethylene. Offers solution for water storage, protected from pollution with the clipped cover and cap. Easy to fill up and pour with the 50 mm opening. Stackable and easy to carry by hand with a strong flat handle on the head with a round bottom shape and a reinforcement ring. Strong and durable quality for a long-life span in tough conditions.

**Technical Specifications**

- **Manufacturing process:** injection moulding.
- **Capacity:** 14 liters.
- **Material:** made of food grade virgin 100% high density polyethylene and virgin LDPE low density polyethylene, according to EN1186-3-9.
- **Weight:** Bucket min. 600 g, cover min. 150 g, handle min. 30 g.
- **Handle:** Plastic, to ensure the easy to carrying by hand with a strong flat handle (i.e. without sharp edges) on the head with a round bottom shape and a reinforcement ring, 60% LDPE + 40% HDPE
- **Lid:** the bucket is supplied with a lid that should be able to close tight, but easy to open and close, 60% HDPE + 40% LDPE
- **Outer diameter of clip on cap:** 60 mm +/-5%
- **Inner diameter of cap:** 52 mm +/- 5%
- **Outer diameter of cap:** 56 mm +/- 5%
- **Reinforced bottom ridge** to prevent scraping of the base.
- **Reinforced top** to prevent ovalling.
- **Curved inside base** to wall join for easy cleaning.
- **Color:** white or blue (specification: Pantone Blue 300 or quadrichrome (CMYK). C = 100%, M = 45%, Y = 0%, K = 0%.)

**Weight and Volume**

**Capacity:** 14 L

**Dimensions, (±5%):**

- Height 300mm.
- Top diameter: 300 mm.
- Bottom diameter: 240 mm.
- Cover with outlet of 50 mm ±10% and clip-on cap.

**Weight:** Bucket min. 600 g, cover min. 150 g, handle min. 30 g.

**Packing**

The buckets should be packed and arranged in a way that maximises loadability on boxes, pallets, and containers. Ideally 20 buckets and covers, with clipped-on handles are packed in one box. Boxes of export quality with minimum 5 ply and reinforced corners. Filled boxes must resist without any damage to a weight or a pressure of 230 kg applied on a strong rigid board on top of the box (equivalent weight to 4 m high stacking). The board size to be at least 100 mm larger than the box in width and length (e.g. plywood 20 mm thickness). The packing must guaranty that the buckets will not be pressed one in other to avoid blocking the buckets together.

**CRI Pallet Details**

Fumigated as per IPSM 15 standard. Dimensions (L x W x H): 1150 x 770 x 144 mm. Maximum height of the packed pallet: 115 cm. Pallets should be shrink-wrapped and strapped. The palletized goods must not exceed the length and width of the pallet. For further information please refer to section IV Pallet Information.

**Optimal Shipping / Container Information**

The bucket must provide stacking possibilities to lower transport costs.

**Loadability without pallet:**

20' DC = 4900

40' DC = 10080

40' HC = 11520

**Loadability with pallet:**

20' DC = 3360

40' DC = 7200

40' HC = 7200

**Manufacturer Marking**

Every unit should include the manufacturer's identification molded on the bucket, at 5 cm above the bottom with letters not higher than 1.5 cm and on the opposite side of the UNHCR logo. The marking should include the manufacture's name, unique reference batch number and the date (month and year) of manufacturing. No company logo should be included with the manufacturer's marking.

**Printing of UNHCR Logo on the Heavy Duty Plastic Bucket**

UNHCR visibility logo printed on the bucket, placed in the center and on the two sides of the bucket. White logo should be printed in blue buckets and blue logo should be printed in white buckets.

**Typeface (Font), Colour specifications for printing:**

Font: Helvetica Bold. Colour specification: Pantone Blue 300 or quadrichrome (CMYK). C = 100%, M = 45%, Y = 0%, K = 0%.

**Expected Life Span and Shelf Life**

It is expected that the bucket will last for a minimum of 2 years. The product should have a shelf life of 5 years.



# UNHCR

United Nations High Commissioner for Refugees  
Haut Commissariat des Nations Unies pour les réfugiés

HEAVY DUTY PLASTIC BUCKET 14 L

UNHCR Item No 07071

## UNHCR Logo Application Reference

UNHCR vertical and horizontal logotypes could be printed. In the case of vertical logotype, the size of the logotype should be of 15 cm width and 15,85 cm height, proportionate to the width without any distortion to the logo and letterings, as per included logo application reference. In the case of the horizontal logotype, the size of the logotype should be of 15,1 cm width and 5.00 cm height, proportionate to the width without any distortion to the logo and letterings.

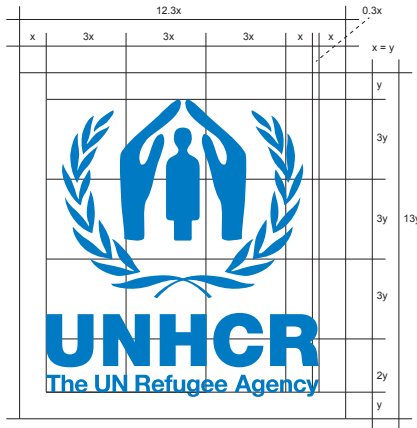

UNHCR Vertical Visibility Logo

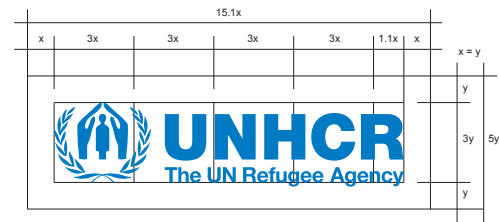

UNHCR Horizontal Visibility Logo

## Graphic Reference

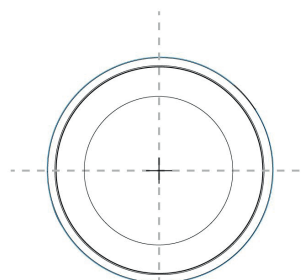
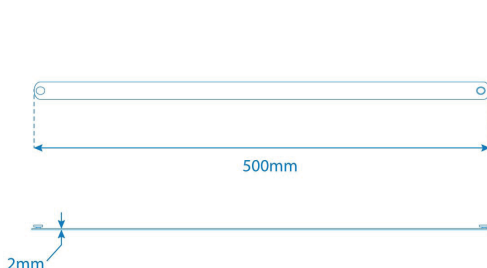
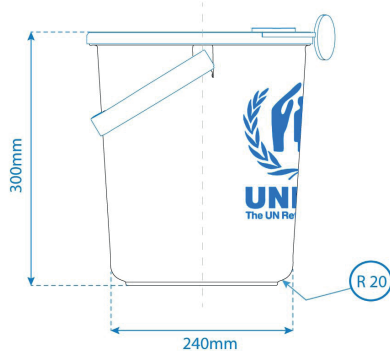
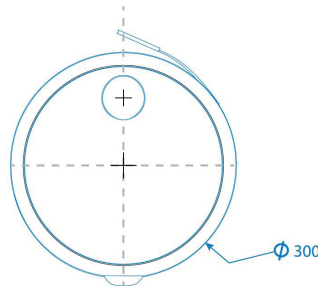

### Technical Drawing

#### Detailed View

Capacity: 14 L

Dimensions, ( $\pm 5\%$ ):

- Height 300 mm.
- Top diameter: 300 mm.
- Bottom diameter: 240 mm.
- Cover with outlet of 50 mm  $\pm 10\%$  and clip-on cap.

Weight:

- Bucket min. 600 g.
- Cover min. 150 g.
- Handle min. 30 g.

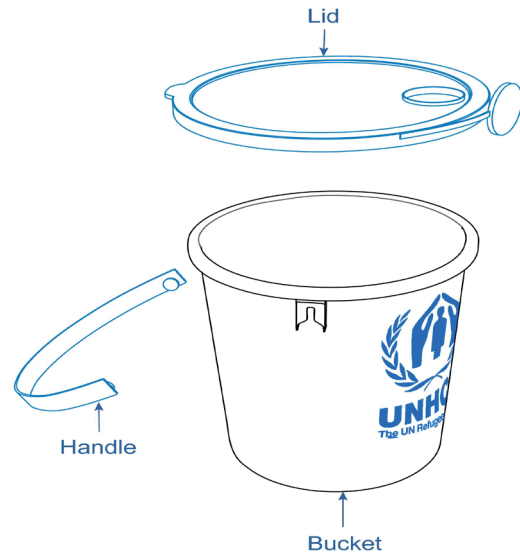

### Product Performance and Quality Control

Several tests should be performed to ensure performance and for quality control purposes including the tests listed below:

- **Impact Resistance\ Drop Test:** The heavy duty plastic bucket must be impact resistant on a hard surface (smooth flat concrete floor). To ensure minimum quality standard the bucket must resist at least to two (02) consecutive drops from 2 m high from the bucket's bottom, containing maximum volume of water (14 liters) at 20 °C, without any damages. See drop test graphic reference below.
- **Flexibility test:** The bucket must get back to its original shape ( $\pm 10\%$  to its original diameter after one hour) without damage after applying a pressure on the two sides of the top rim to make them touch one another in the middle.
- **Handle test:** The handle must resist folding flat on the cover, pushed on left end, and pushed on right end. The handle must also resist to 28 kg traction in normal usage position.
- **Lid test:** The lid should be able to close tight, but easy to open and close. For testing the lid's performance the lid must resist one fall on the side, containing maximum volume of water.

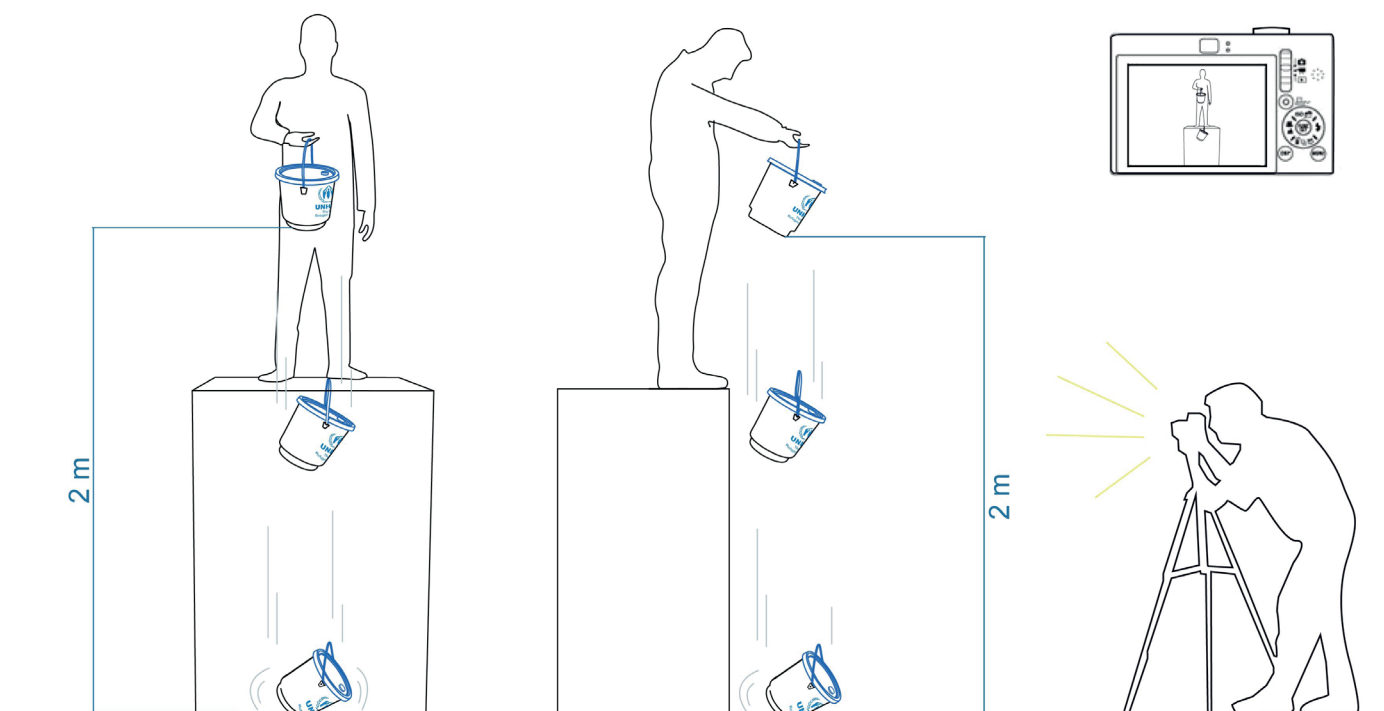

**Packing, UNHCR Logo, and Shipping Marking Reference**

**Sea/Air Transport Carton:**

- For palletizing and transportation, the buckets should be packed and arranged in a way that maximises loadability on boxes, pallets, and containers.
- The UNHCR visibility logo will need to be applied on 5 sides (excluding the bottom of the carton).
- The main objective is to maximize the UNHCR visibility logo and to include a separated space for the description of the product and shipping markings. For this purpose, **the UNHCR visibility logo should occupy a minimum of 60% of the surface space for each side where it is applied.**

**Important:** Priority should be given for the UNHCR visibility logo to be always visible and in a straight and readable position, once the cartons are palletized. In the event that the cartons are wrapped with other materials for better protection, including plastic materials or others, the UNHCR visibility logo should still be always visible during the transport. Taking that into account, UNHCR visibility logo should be applied on those wrapping materials in case of a lack of visibility.

**Integrity and design of UNHCR vertical and horizontal visibility logos:**

While the integrity of the UNHCR visibility logo (hand symbol, acronym and the descriptive phrase “The UN Refugee Agency”, always in English) should be respected, the framed space given for the shipping markings provides flexibility (if necessary) for the preparation of stickers or plastic pockets that will facilitate the marking of the cargo that is shipped initially to global warehouses (eg. Dubai, Copenhagen) and later is shipped to other destinations. Proportionality rules with regard to the size of UNHCR logo, hand symbol, acronym and descriptive phrase “The UN Refugee agency” should be applied following the “X” and “Y” proportionality to avoid distortions on the UNHCR logo and letterings (see graphics below). In the Sea/Air Transport Carton the UNHCR visibility logo should be printed in blue indelible ink for maximum visibility, using typeface and color as described below.

**Typeface (Font), colour specifications for printing:**

Font: Helvetica Bold. Colour specification: Pantone Blue 300 or quadrichrome (CMYK). C = 100%, M = 45%, Y = 0%, K = 0%.

**Packing**

20 buckets are packed in export quality cartons of 110 x 31 x 33 cm. However different packing methods may be accepted in order to maximise loadability in pallets and containers.

Pieces per carton: 20.

Weight of packing unit: 18.5 kg.



# UNHCR

United Nations High Commissioner for Refugees  
Haut Commissariat des Nations Unies pour les réfugiés

HEAVY DUTY PLASTIC BUCKET 14 L

UNHCR Item No 07071

## UNHCR Logo Application Reference

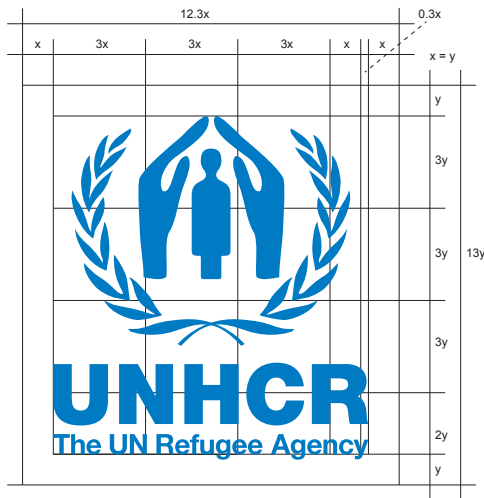

UNHCR Vertical Visibility logo

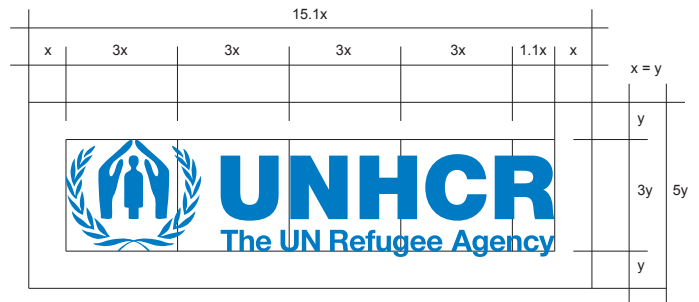

UNHCR Horizontal Visibility logo

## Logo and Shipping Markings on Plastic Bucket Boxes

The front and back of the Sea/Air Transport Carton (the largest surface sides of the carton) should include only the UNHCR visibility vertical logo. The 2 other opposite sides should include the UNHCR visibility vertical logo with the shipping marking information area (below the logo). The top side should include the horizontal visibility logo in one of the closures and the content list in the other closure.

### Opened Box







# UNHCR

United Nations High Commissioner for Refugees  
Haut Commissariat des Nations Unies pour les réfugiés

HEAVY DUTY PLASTIC BUCKET 14 L

UNHCR Item No 07071

## Logo and Shipping Marking Application Reference

### Logo and Shipping Marking for Heavy Duty Plastic Bucket 14 L Packing



#### A. Application of the logo and markings for the front and back sides of the Sea/Air Transport Carton:

In the front and the back sides of the Sea/Air Transport Carton, the vertical logo is to be placed centrally, occupying a minimum of 60% surface space and without any image distortions as per (graphic 1).

In case of a rectangular shape carton, the UNHCR horizontal visibility logo should be used instead of the UNHCR vertical visibility logo, having a better usage of the surface space (graphic 1.2).



(Graphic 1)



(Graphic 1.2)

## Technical Drawing





# UNHCR

United Nations High Commissioner for Refugees  
Haut Commissariat des Nations Unies pour les réfugiés

HEAVY DUTY PLASTIC BUCKET 14 L

UNHCR Item No 07071

## Logo and Shipping Marking Application Reference

### B. Application of the logo in the 2 other opposite sides of the Sea/Air Transport Carton:

In the 2 other opposite sides of the Sea/Air Transport Carton, the vertical logo and shipping marking information are to be placed centrally, occupying a minimum of 60% surface space (45% for the UNHCR visibility logo and 15% for the shipping markings) and without any image distortions, as per (graphic 2).

In case of a rectangular shape carton, the UNHCR horizontal visibility logo should be used instead of the UNHCR vertical visibility logo, having a better usage of the surface space (graphic 2.2)

The information to be placed in the shipping marking box is as follows:

**UNHCR Item name and number:**  
**PO No.:**  
**PO Quantity:**  
**Consignor (supplier/manufacturer):**  
**Consignee:**  
**Destination:**  
**Packing units:** {number / total number} -  
To be marked with consecutive numbers  
shown over the total number of packing  
units comprising the consignment (N/N: i.e  
1/20, 19/20)

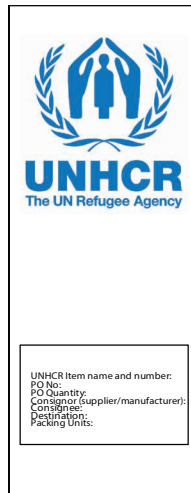

(graphic 2)

**Important:** In order to respect the integrity of the logo, the shipping marking information area should be visually separated from the lower part of the visibility logo and framed with the same indelible ink as the details information as per the graphic 2.

## Technical Drawing

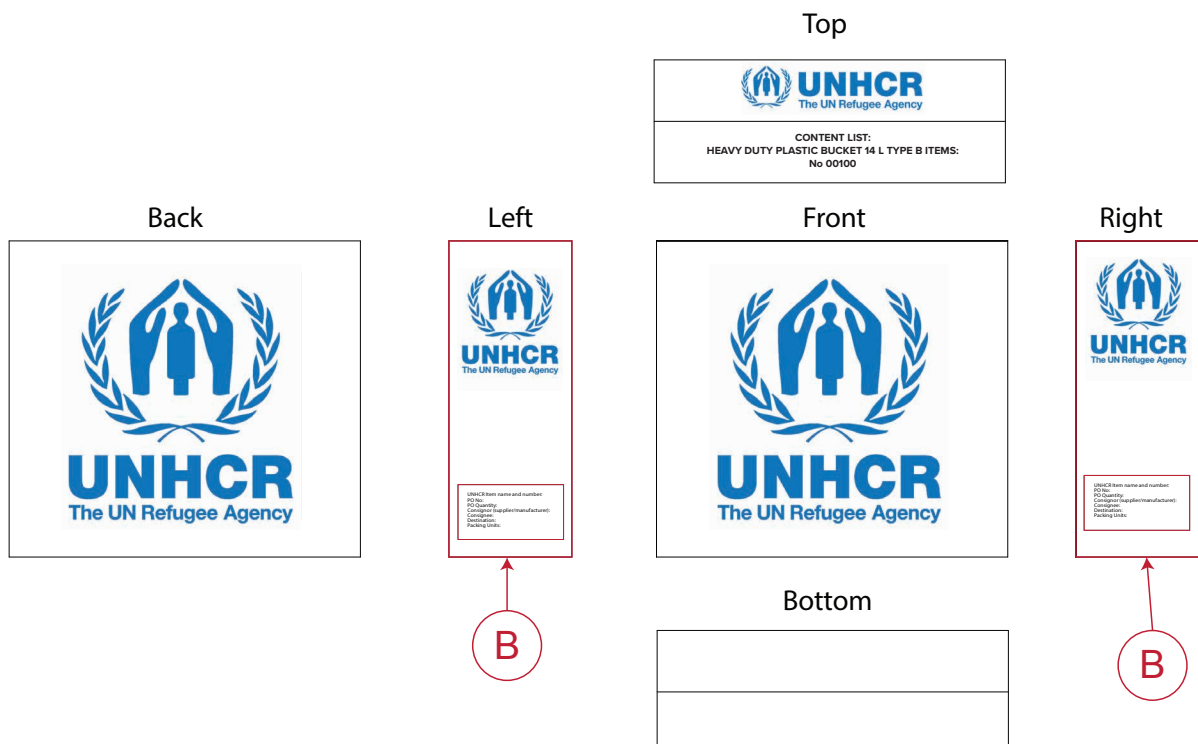



# UNHCR

United Nations High Commissioner for Refugees  
Haut Commissariat des Nations Unies pour les réfugiés

HEAVY DUTY PLASTIC BUCKET 14 L

UNHCR Item No 07071

## Logo and Shipping Marking Application Reference

### C. Application of the logo and marking in the top side of the Sea/Air Transport Carton:

In the top side of the Sea/Air Transport Carton, the UNHCR horizontal logo is to be placed centrally in one of the closures, occupying a minimum of 60% surface space and without any image distortions.



CONTENT LIST:  
HEAVY DUTY PLASTIC BUCKET 14 L  
TYPE B ITEMS: No 07071

## Technical Drawing

