

REHAB WORKS  
AT  
GOVERNMENT TECHNICAL  
INSTITUTE-CENTER OF  
EXCELLENCE, G7 ISLAMABAD



**UNHCR**  
The UN Refugee Agency



**PLANNERS CONSULTANTS ENGINEERS (PCE)**

97-K Industrial Estate, Hayatabad Peshawar Pakistan  
Ph: 0092-91-5816017, 5891661-4, Fax: 5891845  
E-Mail: pce.pesh@yahoo.com

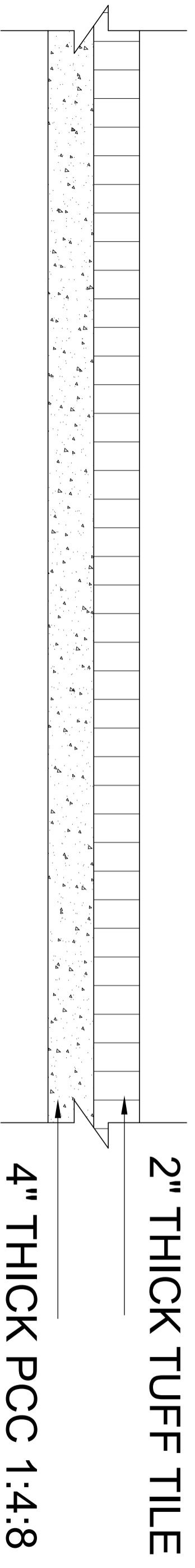

**2" THICK TUFF TILE**

**4" THICK PCC 1:4:8**

# TUFF TILE FLOORING

## 7500.SFT

CLIENT:



CONSULTANTS:

**PLANNERS CONSULTANTS ENGINEERS (PCE)**  
 97-K Industrial Estate, Hayatabad Peshawar Pakistan  
 Ph: 0092-91-5816017, 5891661-4, Fax: 5891845  
 E-Mail: pce.pesh@yahoo.com

SCHOOL NAME

REHAB WORKS  
 AT  
 GOVERNMENT TECHNICAL  
 INSTITUTE-CENTER OF  
 EXCELLENCE, G7 ISLAMABAD

Date of Revision	Prepared By	ARCHITECT
	Designed By	MARWAT KHAN (KARACHI)
	Checked By	(M.Arch. UET, Lahore)
	Approved By	

PROJECT:		
PREPARATION OF DESIGN DRAWINGS & BOOK FOR CONSTRUCTION/REHABILITATION OF SITES		
TITLE:	TUFF TILE FLOORING	
DATE	SCALE	DRG. NO.
SEP 2023		A-01

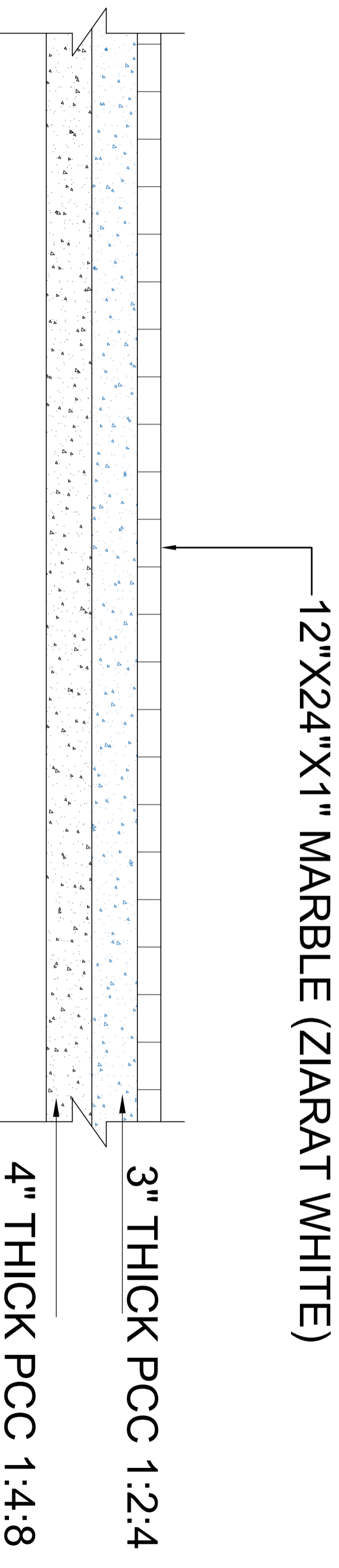

# MARBLE FLOORING

## 2500.SFT

CLIENT:



CONSULTANTS:

**PLANNERS CONSULTANTS ENGINEERS (PCE)**  
 97-K Industrial Estate, Hayatabad Peshawar Pakistan  
 Ph: 0092-91-5816017, 5891661-4, Fax: 5891845  
 E-Mail: pce.pesh@yahoo.com

SCHOOL NAME

REHAB WORKS  
 AT  
 GOVERNMENT TECHNICAL  
 INSTITUTE-CENTER OF  
 EXCELLENCE, G7 ISLAMABAD

Date of Revision	Prepared By	ARCHITECT
	Designed By	MARWAT KHAN ORAKZAI (B.Arch, D.C.E.T Karachi) (M.Arch, UET, Lahore)
	Checked By	
	Approved By	

PROJECT:		
PREPARATION OF DESIGN, DRAWINGS & BOQS FOR CONSTRUCTION/REHABILITATION OF SITES		
TITLE:	MARBLE FLOORING	
DATE	SCALE	DRG.NO.
SEP 2023		A-02