

PLAN

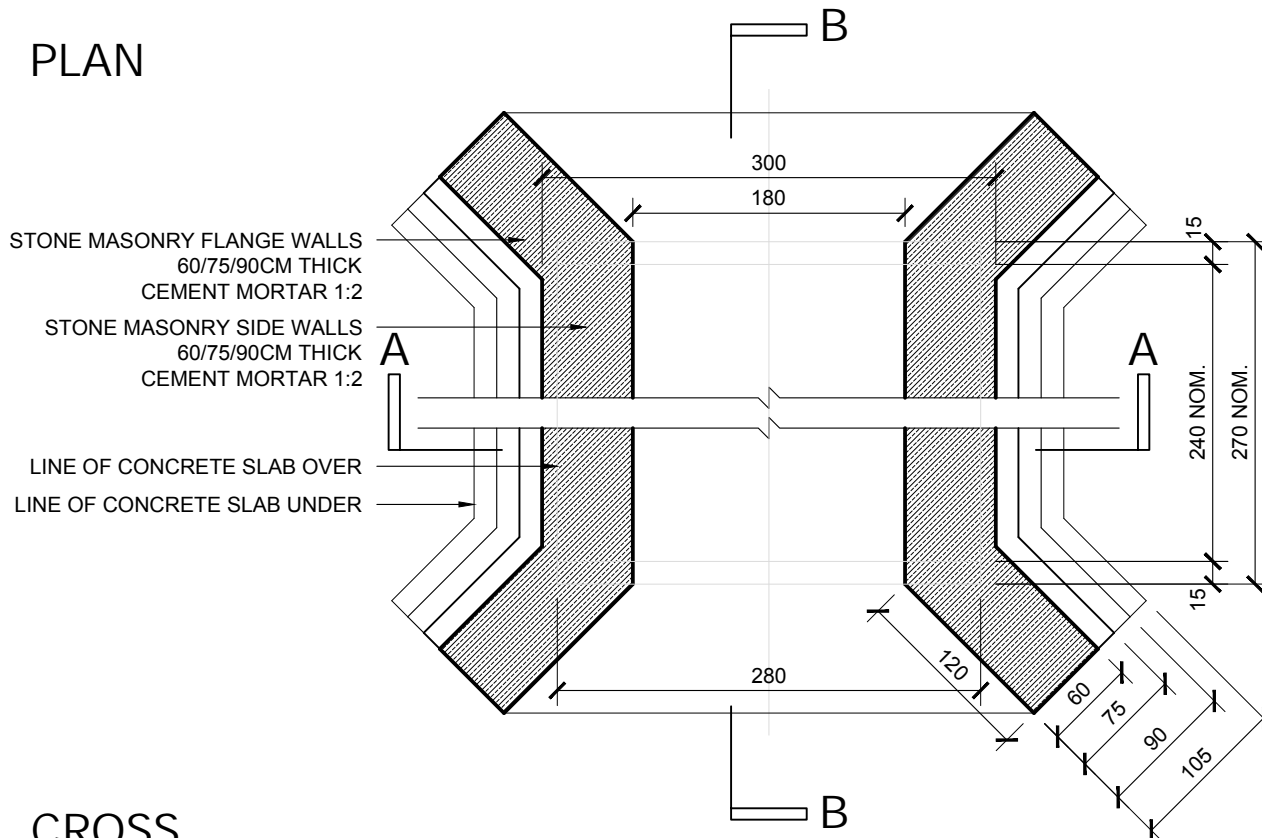

CROSS SECTION AA

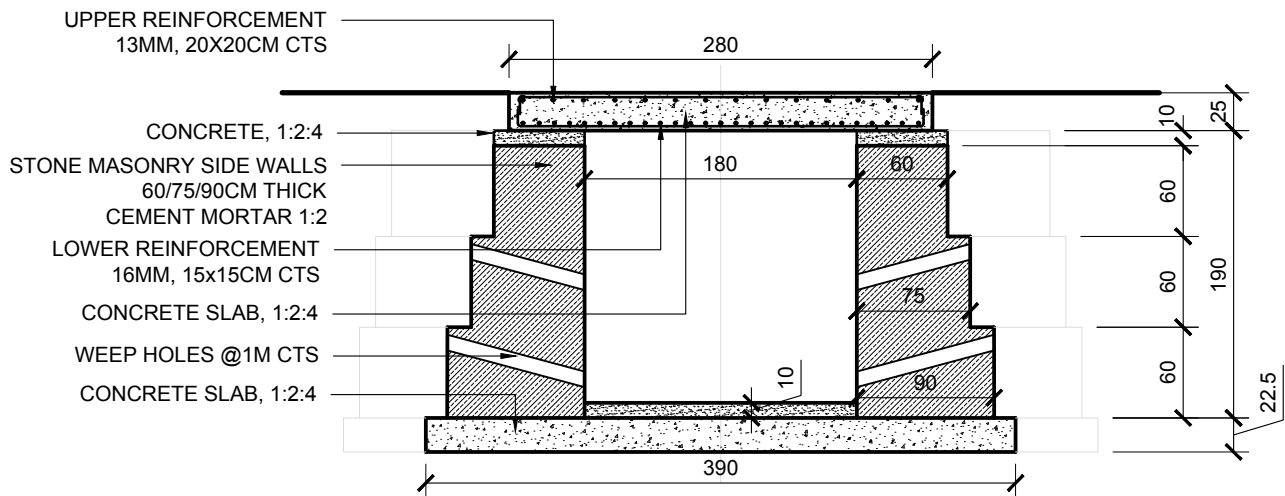

NOTES

1. Refer to Specification for material descriptions.
2. Structural design to be verified by local engineer for compliance with local conditions and norms
3. Ensure the correct water content of mixed concrete - slump test should yield < 1/4 height reduction.
4. Slabs to be cast in a single pour. All concrete works to be vibrated or well rodded.
5. Ensure all poured concrete is kept damp and out of direct sunlight for at least 7 days while curing.
6. Span and height dimensions nominal - adjust to suit site conditions and requirements.

DWG NO.

E2-1

TITLE

Culvert - Stone Masonry
Plan & Cross Section

PROJECT

Community Infrastructure Catalogue

DRAWN BY

AU

CHECKED BY

RN

SCALE

1:50

UNITS

CM

SHEET

1 of 2

DATE

31.08.2023



UNHCR
The UN Refugee Agency

Technical Support Section
Community Infrastructure Catalogue